



# saunum

Saunum Sauna Control Unit **Air IQ**



## THE BEST SAUNA EXPERIENCE TO HAVE!



*I am very glad that you have invested in the Saunum device, and I believe that our innovative technology will offer you a wonderful and extraordinary sauna experience.*

I have a degree in thermal engineering and come from the Southern Estonia, where my love for saunas began. The special feature of local historic smoke saunas is the lower temperature and higher humidity level than, for example, a classic Finnish sauna. In ordinary saunas, the stone volume of the sauna heater is generally small. Such an arrangement can cause a sudden, burning hot steam and an extremely uneven temperature, where your head and shoulder level is really hot, but your feet are left cold. Such an experience can be quite unpleasant and may cause headaches and lead to body stress. However, in ancient smoke saunas and Native American saunas, the stones were first heated during the day. Then the heat stored in the stones was used to cleanse the body and create a truly enjoyable sauna experience.

Inspired by the experience of a smoke sauna, I wanted to create an innovative solution that combines the best features of an authentic sauna with modern technology; enabling a pleasantly mild and relaxing sauna experience without painfully scorching steam. For that, however, I had to solve the problem of how to achieve an even temperature, at both the head and foot levels. My development work was supported by research done alongside Tallinn University of Technology,



in which we analysed the thermal stratification and air movement in the sauna room. Saunum was born in cooperation between scientific thinking and technological innovation.

Saunum's unique patented mixing system of air layers captures the hot steam that rises under the ceiling of the sauna room, mixes it with the cooler air from the surface of the floor, and directs the milder steam back evenly. This makes for an enjoyable, unaggressive heat. You can sit in the sauna for a longer time, and enjoy a sweat and a deep cleanse without feeling tired. The stone volume of our heaters is significantly larger than other sauna heaters, which is the reason for the especially pleasant indoor climate with long and soft steam.

A moist steamy sauna, a sanarium, a therapeutic salt sauna, or a healthy aroma sauna – all of these functions are available on Saunum's devices to create a truly relaxing sauna experience. When using Himalayan salt balls in our device, salt ions that are beneficial to skin and respiratory tract evaporate and the steam circulates these into the air. Adding a sauna aroma system that blends steam and healthy aroma oil creates an even more enjoyable sauna environment.

Saunum's sauna devices are suitable for both adults and children.

**Have a pleasant sauna!**

Andrus Vare  
The creator of Saunum



Saunum **congratulates you**  
on choosing an innovative  
sauna control unit!



# CONTENTS

Warnings and notes _____	6
Using the heater and instructions for bathing _____	8 - 9
Control panel set _____	10
Indicators _____	11
Technical data _____	12-13
Electrical connections _____	14-15
<b>INSTRUCTIONS FOR INSTALLATION</b>	
Installing the control panel _____	16-17
Installing the temperature sensor _____	18
Installing the control power unit _____	20
<b>DIRECTION FOR USE</b>	
Control panel view _____	21
Control panel initial setup _____	22-26
Sauna scheduling _____	27-28
Using the Saunum sauna climate function _____	28
Heating _____	28-29
Warranty conditions _____	30
<b>Installation report</b> _____	31



**All users of this product must read the warnings and manual carefully before using the product! Failure to follow the instructions could result in personal injury, death, fire, and/or property damage, and the device's warranty may be voided.**

**The control panel is meant for controlling the sauna heater and the functions intended for the control unit set.**

**It is not to be used for any other purpose!**

This device should not be used by children, people with reduced mobility or sick people. Children should use the device only under constant and close adult supervision.

Persons with reduced physical, sensory, or mental capabilities, or persons with a lack of experience and knowledge, should use this device only under constant and close adult supervision and only after consulting with a physician.

Before using sauna, all users should consult with a physician to ensure that they have no health conditions that would make sauna bathing unsafe, and discuss time and temperature limitations. Pregnant women should consult their physician before the use of the sauna. Excessive body temperatures have the potential to cause fetal damage during early pregnancy.

Use of drugs, medication, or alcohol before or during the sauna session may lead to dizziness or unconsciousness, resulting in injury or death. No person should use this product while under the influence of alcohol or drugs. Persons taking medications should consult with their physician to ensure that it is safe to use sauna while taking their medications. Users should place a towel between their skin and sauna bench, backrest, or wall while sitting or lounging in the room. When using the sauna, be aware of the dangers associated with going to the sauna. Do not stay in the sauna room for more than 30 minutes at a time.



Prolonged exposure to steam can be harmful or fatal. Users should discontinue using the sauna if they feel light-headed, dizzy, or experience heat exhaustion. It is prohibited to sleep inside the heated sauna. Users should take care to avoid falling asleep while using the sauna.

**The electrical device should only be connected to the power and/or utilities in accordance with all laws and regulations by a licenced, professional, certified electrician.**

**After connecting and installing the control unit set, the installer must inform the sauna owner or operator of all operating requirements.**

**The requirements for use must be given by the owner or operator to everyone who uses the sauna.**

**All maintenance other than regular surface cleaning of the product must be performed by a trained professional.**

**Always disconnect the device from the power and/or utilities before carrying out any maintenance work!**

- Check the control unit set for visible damage before installation and use. Do not use a damaged device or a device that has been modified from

the original manufacturer's condition in any way.

- It is vital to install the device according to the instructions for installation and use. Failure to carefully follow all instructions can cause the risk of fire or short-circuit, leading to property damage, bodily injury, or death.
- No accessories that the manufacturer has not approved should be installed in this device. If suitable accessories are installed in the device, follow the accessory-specific operating and installation instructions!
- If the supply cord is damaged, it must be replaced by the manufacturers' service partner or a similarly qualified licensed, professional, certified electrician to avoid a hazard.
- Clean the control panel by using a lightly moistened cloth. Use only mild cleaning agents, never solvents or corrosive chemicals. Allow the product to dry thoroughly before operation.
- This product should not be disposed of with general household waste. When recycling your product, take it to your local collection facility or contact the place of purchase.



## USING THE HEATER AND INSTRUCTIONS FOR BATHING

- Always check before heating that there are no objects on the heater or near the heaters safety distance described in the heaters manufacturers manual.
- Always check that the heater has switched off and stopped heating after the on-time period has elapsed.
- In public saunas, where the heater is used continuously for longer than the heater timer or the control unit allows for in the factory settings, the device must only be used under constant adult supervision by a person not using the sauna while performing the supervision.
- When the control unit is set to standby mode for remote control or switching, it must be ensured in advance that there are no objects in the sauna room or on the heater that do not match the safety distances specified in the heater manufacturer's instructions.

- Prolonged sauna use can damage your health or cause death.
- Do not stay in the sauna room for more than 30 continuous minutes (in a row).
- Leave the sauna room if you feel sleepy, dizzy, or weak.
- Do not dry objects or living things in the sauna.

## USING THE HEATER WITH THE CONTROL PANEL

The heating elements will automatically turn off when the sauna room reaches the temperature selected on the control panel.

The control unit set will automatically turn the heating elements on and off to maintain the desired temperature.

The heater will turn off when the set time ends, the "Stop" button is pressed, or an error occurs.





## CONTROL PANEL SET

- Controls the sauna temperature and the speed of the Saunum sauna climate device.
- Enables three pre-set sauna types that can be changed and update by the sauna owner.
- Enables the user to select a time for the sauna to be ready for entry and enjoyment.
- Shows notification when the sauna is ready – screen notification. Using the Saunum App, and on your mobile device.
- Languages.
- Touch screen.
- Screen lock / Child lock.
- Overheating protection.
- The desired functions can be selected from the intuitive screen, the numerical values displayed in red can be changed.
- Remote control – with the Saunum mobile app.

Devices with in-app support enabled can also be controlled and configured via a mo-

bile phone.

Remote start of the heater is subject to safety restrictions.

The heater will not start remotely if the control system detects an open circuit (e.g., open door).

For remote activation to function properly, ensure all safety conditions are met.

After completing of the control unit set, the installer should give this manual to the owner of the sauna. The product owner should provide access to the manual to all persons using or operating the sauna. Please read more instructions for installation, use, and recycling in the original user manual of the control unit. Saunum reserves the right to modify this manual from time to time, and modifications will be posted to **[www.saunum.com](http://www.saunum.com)**. Failure to follow the instructions could result in personal injury, death, fire, and/or property damage, and the device's warranty may be voided.



## CONTROL PANEL SET

The Saunum Air IQ sauna control panel set consists:

1. **control panel**
2. **power unit**
3. **temperature sensor**
4. **temperature sensor and control panel wires**

Using the Air IQ control panel, you can preset the desired temperature, date, and time, switch the heater on and off, and control the fan speed of the Saunum sauna climate device.

The sauna room temperature is regulated based on data measured and transmitted by the temperature sensor.

The sensor is equipped with an overheat protection feature and is located inside the temperature sensor housing (see p. 18).

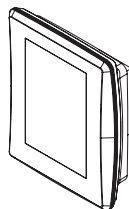

1.

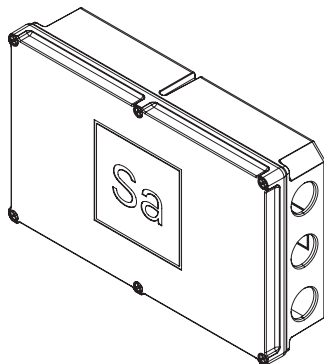

2.

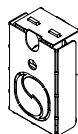

3.

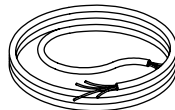

4.



## INDICATORS



**"Sauna ready"  
starting time**



**Temperature**



**Sauna duration**



**Ventilator**



**Ventilator speeds**



**Light**



**Heater power kW**



**Glass surface volume**



**Sauna room volume**



**Screen lock / Child lock**



**Move to next view**



**Value increase**



**Value decrease**



**Repeat sauna  
session**



1. Menu
2. Light
3. Time
4. Heater state
5. Wi-Fi connection



## TECHNICAL DATA

### CONTROL PANEL (IP20):

- Temperature adjustment range:  
104–194 °F (40–90 °C).
- Pre-setting the schedule for the week.
- Allows you to set the operating time of  
1 hours in a private and a public sauna.
- For longer operating times, consult the  
importer/manufacturer.
- Saunum climate device fan three-speed  
control.
- Dimensions:  
0.8 × 3.3 × 4.1 in. (20 × 85 × 105 mm).
- Working temp. range:  
-4 °F to 122 °F (-20 °C to +50 °C).

### POWER UNIT (IP44):

- Supply voltage: 240V N~.
- Heater power rating up to 15.2 kW.
- Dimensions:  
2.36 × 10.11 × 6.5 in. (60 × 257 × 165 mm).
- Safety device: overheat protector.



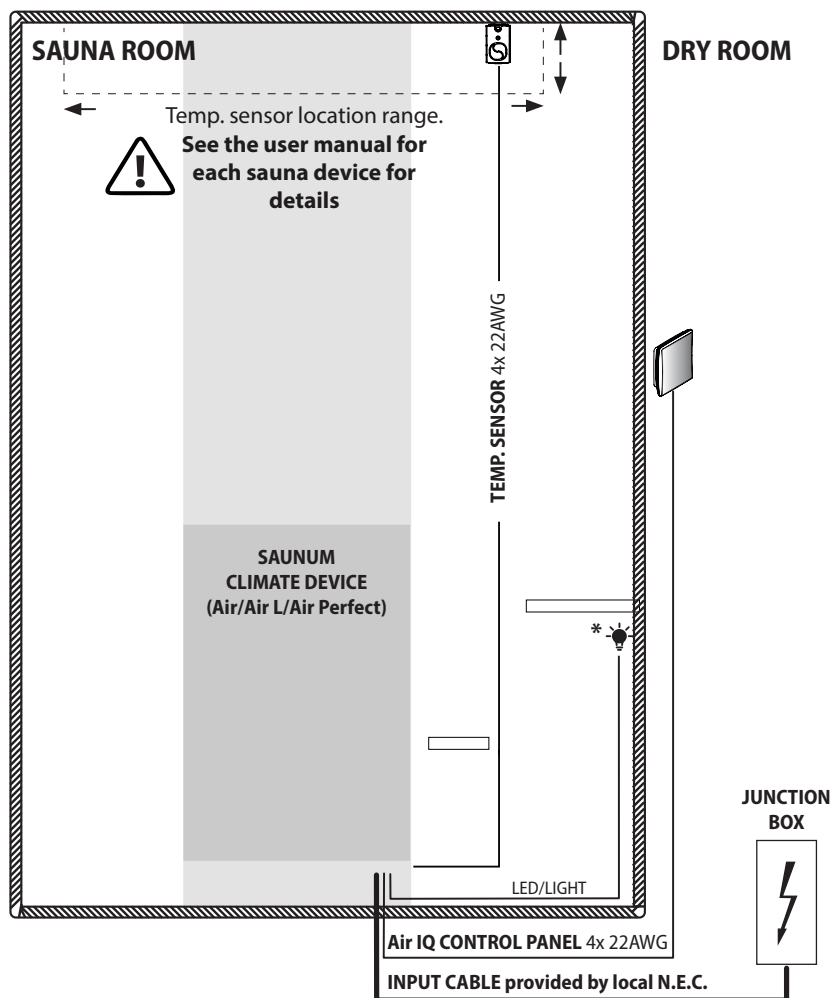

\*The ability to turn on the light from the Air IQ control device.  
Light sold separately.



## ELECTRICAL CONNECTIONS

The connection of the power unit is shown on the diagram of electrical connections.

For more information on connecting the heater, see the heater installation and operating instructions.

If the connection and installation cables are located higher than 40 in. (1,000 mm) from the sauna room floor or routed inside the walls, they must be rated to withstand temperatures of at least 257 °F (125 °C) (e.g., SSJ-type cables). Electrical equipment installed in the sauna room below 40 in (1,000 mm) from the floor must be rated for at least 194 °F (90 °C) (e.g., T125-class components).

### RECOMMENDED CABLE DIAMETERS

**Temperature sensor** - thermal protection

(silicone or other heat-resistant material rated for at least 284 °F / 140 °C):

min 4 x 0,25 mm  
(approx. 24 AWG)

**Control panel** (a ferrule extension sleeve is required for stranded cables):

min 4 x 0,8 mm<sup>2</sup>  
(approx. 18 AWG)

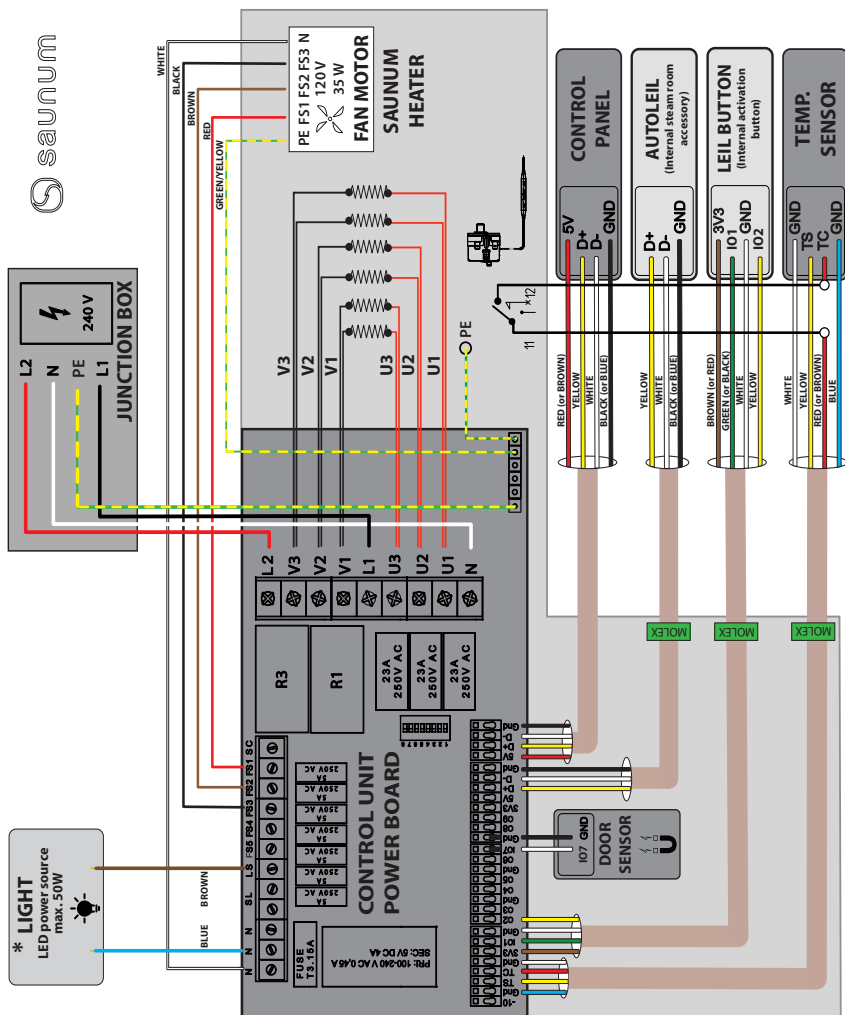

\* The power supply for LED lights (max 50W) must be equipped with an inrush current limiter.

For loads exceeding 50W, the circuit must be used for switching purposes only.

\*\* Optional wires included depending on model configuration



## INSTRUCTIONS FOR INSTALLATION

**WARNING! Failure to install the product in accordance with all instructions herein will void the warranty. It can result in the risk of fire and/or electrical short-circuiting, leading to property damage, bodily injury, or death.**

A licensed professional electrician may only do the installation of the control unit in accordance with current regulations. The person in charge of the installation should provide the necessary training and return the user manual to the product owner after completing the installation. The product owner should provide access to the manual to all persons using or operating the product.

## INSTALLING THE CONTROL PANEL

For concealed installation, the data cable can be installed in a protective tube with a diameter of 1/2 in. inside the wall; if this is not possible, it must be installed on the wall surface.

The control panel must be installed on the wall outside of Sauna Room, in a place protected from water splashes. Has to be inside protective enclosure when outdoor.

- 1. Remove the wall mount from the device.**

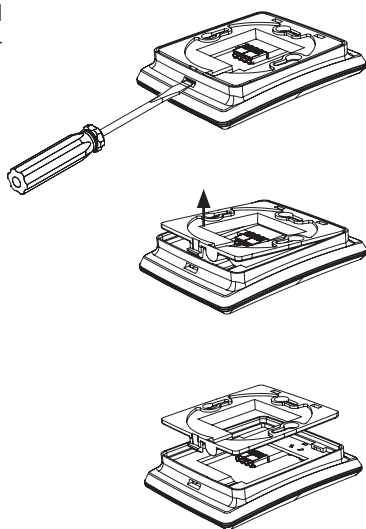





2. Thread the data cable through the hole in the wall mount and fasten the wall mount to the wall with screws.



4x 22AWG

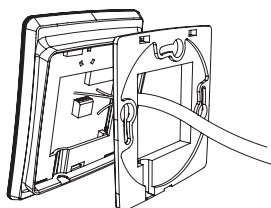
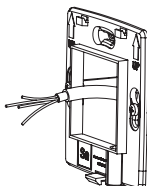
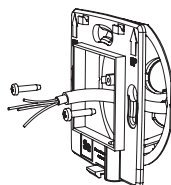

3. Connect the data cable to the Air IQ panel connector.

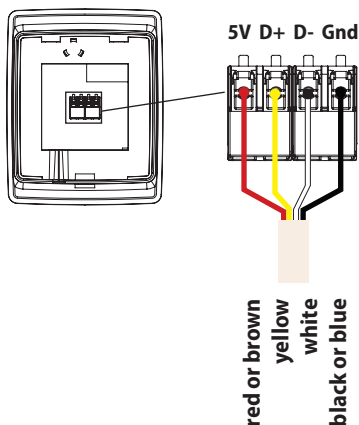

4. Press the Air IQ control panel into the wall mount.

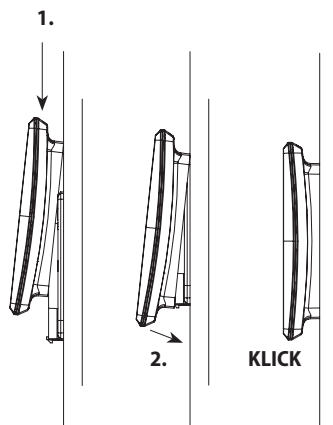



## INSTALLING THE TEMPERATURE SENSOR



To install the temperature sensor/overheating protection, proceed as follows.

- Connect the cable to the temperature sensor's plugs.
- Screw the temperature sensor onto the wall (see figure).
- The temperature sensor cannot be placed above the heater. See the user manual for each Saunum climate device (Air/Air L, Air Perfect) for details.

The temperature sensor can't be any air opening (ventilation, door, or window).

The airflow near an air vent cools down the sensor, giving the control unit inaccurate temperature readings.

As a result, the heater might overheat.

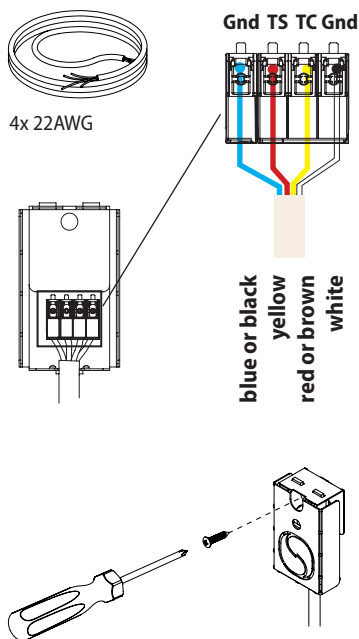



Air IQ control panel is displayed "THERMAL CUTOFF" - the thermal protection of the temperature sensor and/or Saunum climate device has been activated. This results in the fan and device shutting down for safety reasons.



**Airflow near a ventilation opening may cool the sensor, which can result in the control unit receiving incorrect temperature readings. This may lead to overheating of the heater.**

The sensor housing includes a temperature sensor and a thermal cutoff fuse. The temperature sensor detects the sauna room temperature. If overheating occurs, the thermal protection disconnects the power supply to the heater. The cutoff fuse can be manually reset.

#### **To restart the device:**

Cool the sauna room down by approx. 68 °F (20 °C) for 5–10 minutes by keeping the sauna door open. Then reset the safety switch by pressing the brown reset button on the sensor until you hear a click. After pressing the reset button, the device must also be restarted.

**NOTE! The cause of the shutdown must be identified before attempting to reset the system.**

**NOTE! The location of the device safety switch is shown in the device manual.**

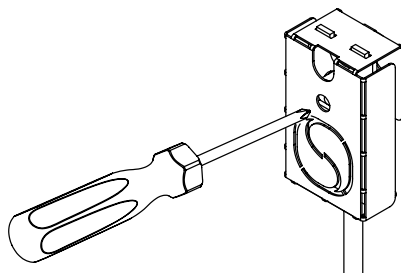
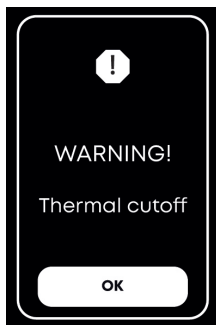



## INSTALLING THE POWER UNIT

The installation spot must be dry, and its temperature must not exceed 113 °F (45 °C).

1. Open the cover of the power unit.

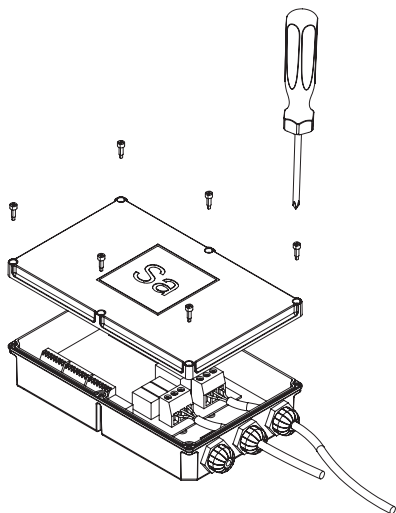

2. Drill holes in the case and attach the power unit to the wall or electrical panel.

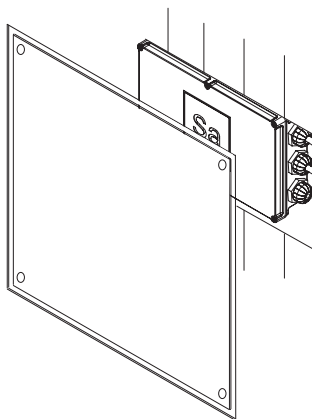
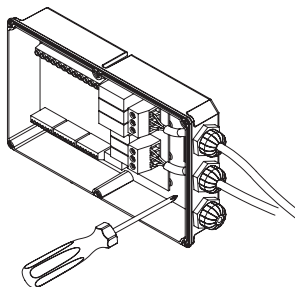



## CONTROL PANEL

### VIEWS

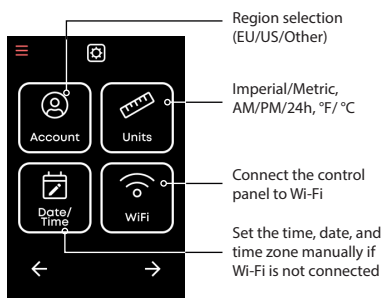

Views 3

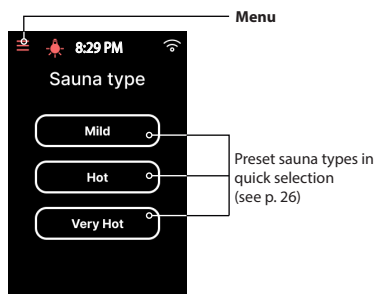

Views 1

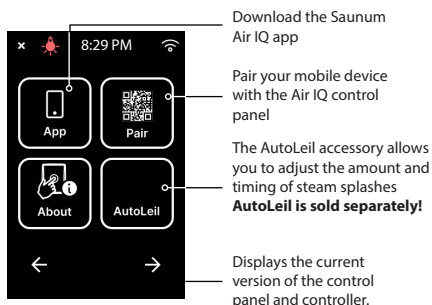

Views 4

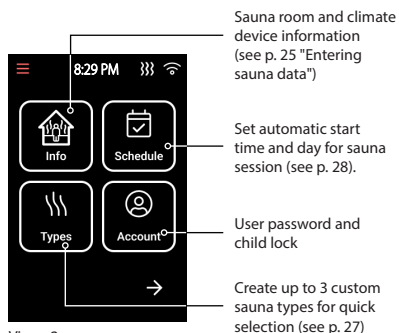

Views 2

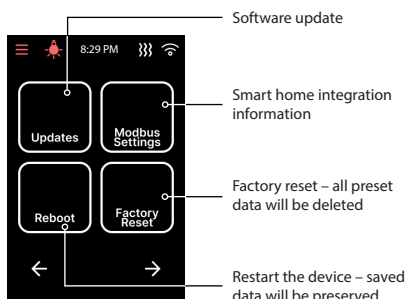

Views 5



## CONTROL PANEL INITIAL SETUP



Saunum's Air IQ automation system is continuously developed to add new features that improve ease of use.



Saunum notifies customers about all updates to customers, and an internet connection is required to download them.

To ensure the automation software stays up to date even if not permanently connected to Wi-Fi, a mobile phone internet hotspot must be used to access and download updates.

During the initial installation of the control system, internet access must be provided, and updates should be downloaded immediately.

The regional setting must be configured according to the region where the device is installed. The device is manufactured according to EU/US standards.

Saunum and its resellers are not responsible for any consequences resulting from the incorrect region selection.

1. When the device is started for the first time, the control panel will display "Setup".

To begin, select the language and region.

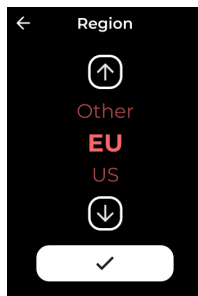
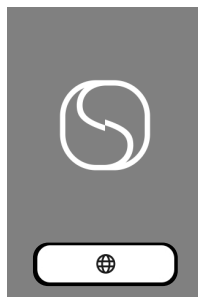



## 2. Connecting to Wi-Fi.

Select **"Setup"** -> **"Connect Wi-Fi"** -> choose a **Wi-Fi network** -> enter the password.



If you do not wish to connect the control panel to a Wi-Fi network, select **"Set up offline"**.



**The control panel must be installed in a location with a sufficiently strong Wi-Fi signal.**

**Check the signal strength at the installation site using your mobile phone, follow these steps:**

- Turn off mobile data on your phone.
- Turn on Wi-Fi on your phone.
- If the Wi-Fi signal at the installation site is strong and other applications that require data are working, the connection is sufficient.

**If the Wi-Fi signal is weak, try the following:**

- Test the network connection of the control panel in a different location.
- If possible, relocate the Wi-Fi router to improve the connection to the control panel.

**Wall materials, recessed installation of the control panel, and other factors may interfere with the Wi-Fi signal.**

**Tip!** To improve network coverage, you can use a Wi-Fi range extender.

**The Saunum Wi-Fi-enabled control panel is designed for controlling Saunum climate devices. To control sauna heaters from other manufacturers, please consult Saunum technical support.**



### 3. Downloading the Saunum app.

With the control panel, it is also possible to:

- Set and monitor the sauna temperature.
- Switch on and set the speed for the Saunum sauna climate function.
- See the heater status information.
- Set a scheduled start.

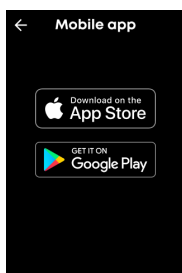

The Saunum Mobile App is a mobile application that allows you to control the Saunum control panel remotely.

### 4. Opening the Saunum app download.

Scan the QR code on the control panel to open the Google Play or App Store page and download the Saunum app.

Then:

- Create an account using your email address.
- A verification code will be sent to your email.
- Enter the verification code to start using the app.



### 5. Pairing the air iq control panel with a mobile device

To pair the Ait IQ control panel with your mobile device, scan the QR code displayed on the control panel.







## 6. Setting units

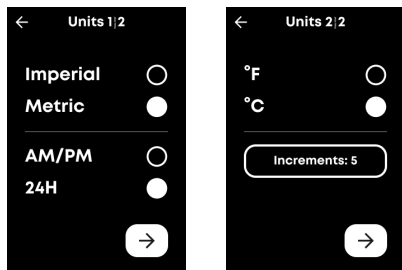

## 7. Setting the time zone.

The local time zone (UTC) configuration is required if the sauna control panel has been previously connected to the Wi-Fi network.



If the control panel is not connected to a Wi-Fi network, configure the settings manually.

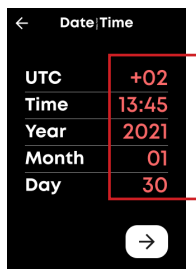

## 8. Entering sauna data:

Select the sauna climate device model and its power from the list.

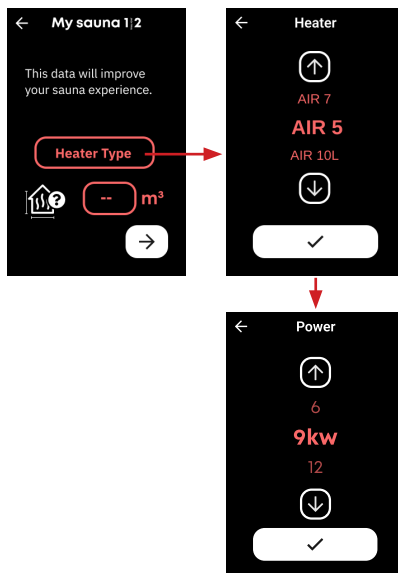

## 9. Entering sauna data:

Set the size of the sauna room.

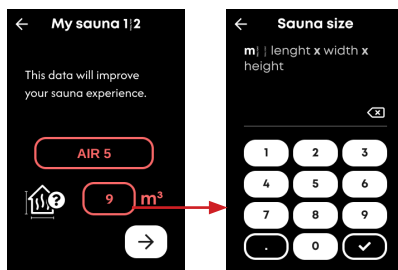



## 10. Entering sauna data:

Set the size of the glass surfaces in the sauna room. Glass surfaces affect the heating time, as glass does not retain heat as well as insulated sauna materials.



## 11. Setting passwords

Set a code to unlock the screen. This feature prevents children from turning on the sauna climate device. If you do not wish to enable the screen lock, press "Skip".

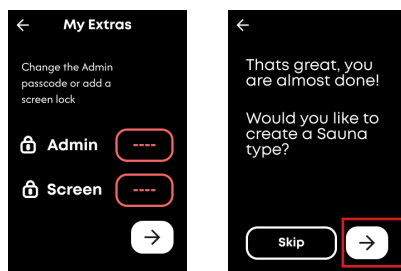

## 12. Creating a sauna type

You can set up to 3 custom sauna profiles by naming them and configuring the temperature, session duration (starting from heating), and the fan speed and runtime of the sauna climate device. Presets allow you to start a sauna session with a single tap. The settings can be changed at any time, including during heating or while using the sauna.

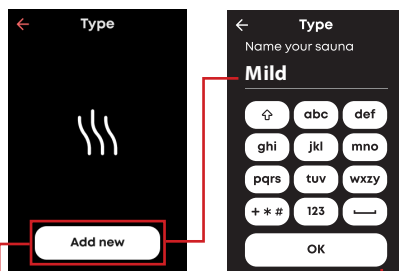

12.1 Enter a name for the sauna session.

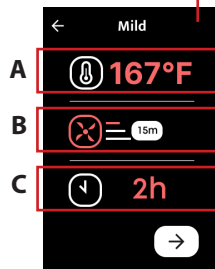

12.2 Set the session parameters: desired temperature (A), fan speed and duration (B), and sauna duration starting from heating (C).



## SAUNA SCHEDULING

Saunum allows you to schedule a sauna in advance by setting up a weekly schedule.

**! Before setting up a scheduled sauna session, make sure there are no foreign objects on the sauna climate device's stones or within its permitted safety distance.**

The safety distances are provided in the user manuals for the sauna climate device models.

**! Heating will not start if the sauna room door is open at the scheduled time.**

### 1. Open the Menu "Schedule"

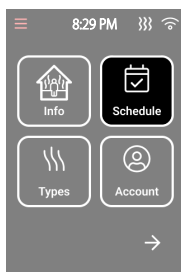

### 2. Set the desired day

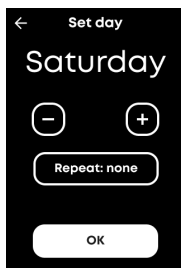

Select the day and choose whether you want to repeat the same sauna session daily, weekly, or not at all.

### 3. Setting the time.

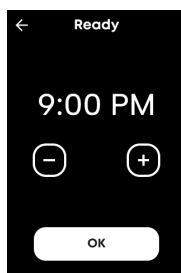

Set the time when you want the sauna to be ready on the selected day.

### 4. Setting the sauna type.

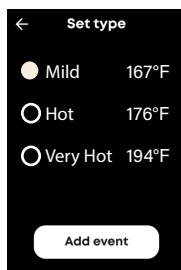

Select a suitable preset steam type (**see p. 26**) for the desired day and time.

If no steam types have been configured yet, you can choose from "Mild", "Hot", or "Very Hot". By default, the target temperature for these steam types is 176 °F (80 °C), and the duration is 2 hours.



Once the desired settings are configured, press "Add Event".

You can add up to 10 schedules if needed.

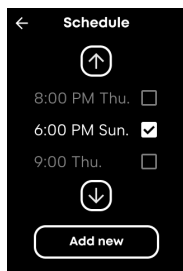

Once you have paired the Air IQ control panel with your mobile device (see p. 24), the mobile app will notify you shortly before the scheduled heating begins.

To cancel the heating, select "Cancel". If not canceled, the heating will start as scheduled.

Once the target temperature is reached, the target temperature will be maintained for 30 minutes, after which heating will stop unless manually extended.

## SAUNUM SAUNA CLIMATE DEVICE CONTROL FUNCTION

**WARNING!** Do not use the climate function (fan) during the heating phase, as it may prolong heating time and cause overheating.

Use the sauna climate device only during a sauna session. To prevent overheating, the climate system may also activate automatically. Do not leave the climate device running unattended!

## HEATING

To start heating the sauna, tap the control panel. If you have preset sauna types, they will be displayed. When you select one of the three available presets, a new window will open. Press "Start" to begin.

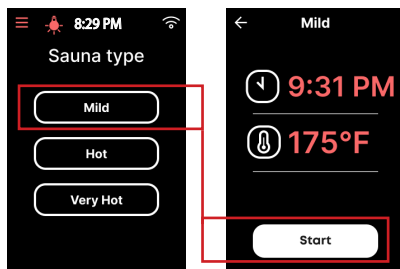



Sauna heating will start, and the screen will display the current sauna room temperature and the estimated time until the sauna is ready.

When the desired target temperature is reached, "Ready" will be displayed on the screen.

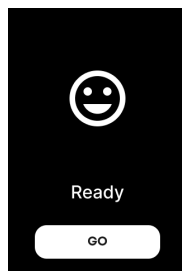
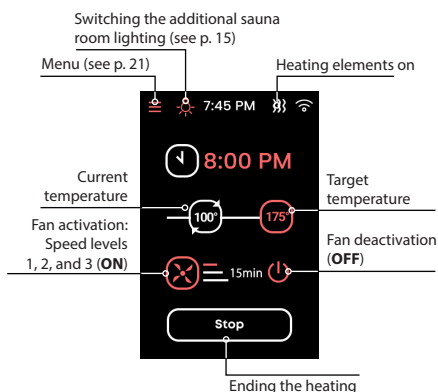

In the "Steam Type" window of an unconfigured control panel, the default options are "Steam Type 1", "Steam Type 2", and "Steam Type 3". Select the desired target temperature and press "Start". Fan speed and duration must be set manually once the target temperature is reached.



## WARRANTY CONDITIONS

The Saunum warranty starts from the date of purchase and includes all manufacturer-provided parts of the control unit. The warranty covers faults from the manufacturing and materials only. Under this warranty, Saunum will provide replacement parts to the buyer, but only after the faulty parts have been returned to the manufacturer or reseller. Replacement of any part in the control unit by Saunum does not extend the original warranty period.

The electrical device should only be connected to power and/or utilities in accordance with all laws and regulations by a licensed, certified electrician.

The warranty applies only to the first installation of the product and to the original purchaser.

- The warranty is only valid if a completed installation report is submitted with the claim;
- The device is connected to the the power and/or utilities in accordance with all laws and regulations by a licensed, certified electrician;

- A warranty period of two (2) years applies to the Device if it is used in a private sauna;
- A warranty period of one (1) year applies to the Device if it is used in a public sauna.

### The warranty does not cover:

- Routine maintenance and cleaning of the device, and replacement of the components due to normal wear and tear;
- Adaptation or modification of the device for any purpose other than that indicated in the instructions for use;
- Risks arising from transport;
- Damage resulting from the misuse of the device;
- Damage resulting from the improper installation of the device;
- Repairs to the device not carried out by Saunum's recommended repair and maintenance partner;
- Accidents, lightning, water, fire, improper ventilation, or any other factor beyond the control of Saunum.



## INSTALLATION **REPORT**

Saunum sauna's control unit model: \_\_\_\_\_

Date of purchase: \_\_\_\_\_

Original purchaser: \_\_\_\_\_

Place of installation: \_\_\_\_\_

Purchased from: \_\_\_\_\_

Date of electrical installation: \_\_\_\_\_

Signature of the installer: \_\_\_\_\_

Notes: \_\_\_\_\_

Customer's contact (name, email address): \_\_\_\_\_

Work accepted: \_\_\_\_\_

**Start date of warranty:** \_\_\_\_\_

For Saunum installation and maintenance help contact with your local distributor:

**techsupport@bathingbrands.com**

**phone: +1 (224) 253-5909**

**Please note!** The sauna may only be connected to the power network by a qualified electrician in accordance with the local NEC.

Read all of the instructions for use carefully and thoroughly **before using the device** and keep them in a safe and easily accessible place for future reference.



Sauna Heater  
E525245

Manufacturer: Saunum Saunas North America LTD  
Suur-Paala 19,  
11415 Tallinn, Estonia

declares that the product:

## **Saunum Sauna Control Unit Set Air IQ**

complies with the requirements of the following standards:

UL 875, Electric Dry-Bath Heaters, Edition 9, Revision Date 01/04/2021;  
CSA C22.2 No. 164, Electric Sauna Heating Equipment, Edition 2,  
Issue Date 02/2018.

These products do not contain hazardous substances in excess of 0.1% (SVHC) and meet the requirements of the REACH Regulation (1907/2006/EU REACH XVII) and comply with the requirements of the RoHS Directive (2011/65/EU, RoHS2 and 2015/863/EU, RoHS3)